

COMMERCIAL DOOR 5000

WIND CERTIFIED DOOR

SERIES

DBCI's Commercial Steel Curtain Roll-Up Door Solutions Include:

1900 Series (1950 Insulated)

- 26-gauge Grade E galvanized

2000 Series (2250 Insulated)

- 16-gauge galvanized steel drums with steel ball bearings
- 26-gauge Grade E steel curtain

2500 Series (2750 Insulated)

- Heavy duty
- 10-gauge steel slide bolt lock
- Width up to 18 feet

5000 Series (5250 Insulated)

- Aluminum bottom bar with steel angle reinforcement
- Wind certified up to 20' wide

When it comes to withstanding Mother Nature's wrath, DBCI has the doors you need. Our 5000 Series utilizes deep engagement guides and side curtain windlocks that are designed to maintain the operation integrity of the door and meet most state and local building codes, especially in coastal regions and Florida. The 5000 Series is made of 26-gauge, Grade E hard steel to ensure quality and dependability. DBCI's commercial-grade steel curtain roll-up doors are designed to meet and/or exceed operational requirements for commercial doors with little or no maintenance.



Integrity. Partnership. Quality.

Fueled by constant changes in local and national building codes, as well as increasing insurance costs, doors with validated wind certification can dramatically reduce maintenance and replacement costs and minimize downtime. DBCI's wind-certified doors are designed to meet stringent building codes in coastal regions and Florida.

Curtain

- 26-gauge galvanized, Grade E hard steel
- Deep-ribbed corrugation with three-rivet windlock attachment
- Maximum opening size of 20' x 16'
- Flexible wear strips
- **NOTE:** The 5000 Series are wind rated up to 20'0" wide and approximately 120 MPH. The MPH rating increases as the door width decreases. For test results on doors up to 20'0" wide, please contact DBCI Sales at 800.542.0501.

Approximate* MPH Certification

- 10' wide = 150 mph
- 12' wide = 150 mph
- 14' wide = 146 mph
- 16' wide = 140 mph

*For test results on doors up to 20' wide, please contact DBCI Commercial Sales at 800.542.0501.

Bottom Bar

- 6063 – T6 aluminum extrusion
- 2" x 1 1/2" galvanized angles
- Bulb astragal
- Stainless steel nuts and bolts

Axle-Drum Assembly

- 1 5/16" O.D. steel axle, 14-gauge
- 11-gauge axle on doors over 10' wide
- Utilizes 12", 16-gauge drums
- Shielded steel ball bearings in drums
- Full top sheet
- Oil tempered torsion springs

A.C.E. Guide System

- 12-gauge galvanized steel
- 12-gauge wind lock bar
- Adjustable bolt on head stop
- Polyethylene wear strip
- Pre-punched for lock and attachment fasteners

Hardware

- Saddle clamps with set fasteners
- 10-gauge slide locks; 2 per door
- 16-gauge step plate; 2 per door
- 1/4" steel angle T-bracket

Opening Height Headroom

- Doors up to 10' have 20" of headroom
- Doors 10' to 14' have 22" of headroom
- Doors over 14' have 24" of headroom

Options

- Insulated 5250 Series
- Chain hoist 8:1 reduction
- Header seal
- Hood
- Steel mounting plates
- Electric operator

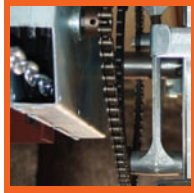
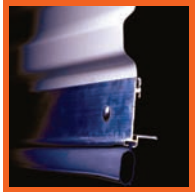

INTERIOR ELEVATION

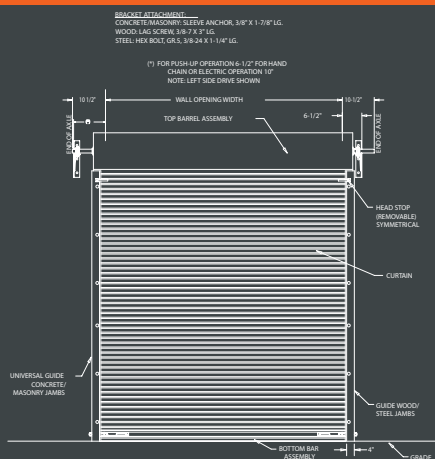

DOOR ENGAGEMENT

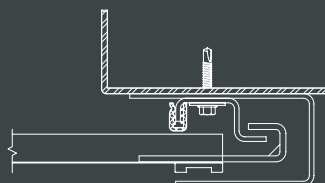

GUIDE DETAIL

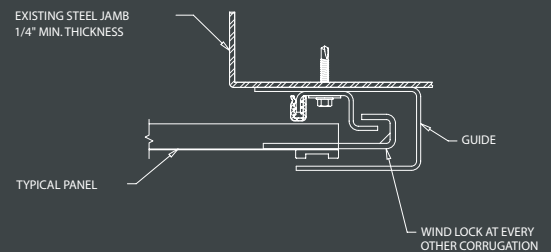

GUIDE MOUNTING

